

ISO/VDMA PROFILE CYLINDERS PRA/182000/M

Double acting – Ø 32 to 125 mm



Conforms to ISO 15552, ISO 6431, VDMA 24562 and NFE 49-003-1

Profile barrel with concealed tie rods

High performance, stability and reliability

Polyurethane seals ensure efficient low friction operation and long life

Switches can be mounted flush with the profile barrel

TECHNICAL DATA

Medium:

Compressed air, filtered, lubricated or non-lubricated

Operation:

Magnetic piston, adjustable cushioning

Operating pressure:

1 ... 16 bar

Operating temperature:

-20°C ... +80°C max.

Consult our Technical Service for use below +2°C

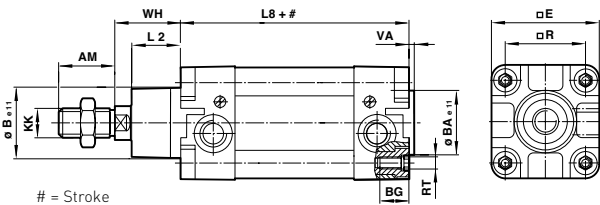

Dimensions

Dia. Ø	AM	Ø BA/Be11	BG	E	KK	L2	L8	R	RT	VA	WH
32	22	30	16	47	M10x1,25	20	94	32,5	M 6	3	26
40	24	35	16	53	M12x1,25	22	105	38	M 6	3,5	30
50	32	40	16	65	M16x1,5	27	106	46,5	M 8	3,5	37
63	32	45	16	75	M16x1,5	29	121	56,5	M 8	4	37
80	40	45	17	95	M20x1,5	33	128	72	M 10	4	46
100	40	55	17	115	M20x1,5	36	138	89	M 10	4	51
125	54	60	20	140	M27x2	45	160	110	M 12	6	65

Models

Model	Dia. Ø	Stroke length	Port size	Piston rod Ø	Reed switch with integral 5 m cable	Banjo flow control	Straight fitting	Elbow fitting	Service kit
PRA/182032/M/25	32	25	G1/8	12	M/50/LSU/5V	C0K510618	C02250618	C02470618	QA/8032/00
PRA/182032/M/50	32	50	G1/8	12	M/50/LSU/5V	C0K510618	C02250618	C02470618	QA/8032/00
PRA/182032/M/80	32	80	G1/8	12	M/50/LSU/5V	C0K510618	C02250618	C02470618	QA/8032/00
PRA/182032/M/100	32	100	G1/8	12	M/50/LSU/5V	C0K510618	C02250618	C02470618	QA/8032/00
PRA/182032/M/125	32	125	G1/8	12	M/50/LSU/5V	C0K510618	C02250618	C02470618	QA/8032/00
PRA/182032/M/160	32	160	G1/8	12	M/50/LSU/5V	C0K510618	C02250618	C02470618	QA/8032/00
PRA/182032/M/200	32	200	G1/8	12	M/50/LSU/5V	C0K510618	C02250618	C02470618	QA/8032/00
PRA/182032/M/250	32	250	G1/8	12	M/50/LSU/5V	C0K510618	C02250618	C02470618	QA/8032/00
PRA/182032/M/320	32	320	G1/8	12	M/50/LSU/5V	C0K510618	C02250618	C02470618	QA/8032/00
PRA/182032/M/400	32	400	G1/8	12	M/50/LSU/5V	C0K510618	C02250618	C02470618	QA/8032/00
PRA/182032/M/500	32	500	G1/8	12	M/50/LSU/5V	C0K510618	C02250618	C02470618	QA/8032/00

Accessories



If you can't see the option you require...

...call the Express hotline now!

For further information
www.norgren.com/info/nec/en035



ISO/VDMA PROFILE CYLINDERS PRA/182000/M

Double acting - Ø 32 to 125 mm

Models

Accessories

Model	Dia. Ø	Stroke length	Port size	Piston rod Ø	Reed switch with integral 5 m cable	Banjo flow control	Straight fitting	Elbow fitting	Service kit
PRA/182040/M/25	40	25	G1/4	16	M/50/LSU/5V	C0K510628	C02250628	C02470628	QA/8040/00
PRA/182040/M/50	40	50	G1/4	16	M/50/LSU/5V	C0K510628	C02250628	C02470628	QA/8040/00
PRA/182040/M/80	40	80	G1/4	16	M/50/LSU/5V	C0K510628	C02250628	C02470628	QA/8040/00
PRA/182040/M/100	40	100	G1/4	16	M/50/LSU/5V	C0K510628	C02250628	C02470628	QA/8040/00
PRA/182040/M/125	40	125	G1/4	16	M/50/LSU/5V	C0K510628	C02250628	C02470628	QA/8040/00
PRA/182040/M/160	40	160	G1/4	16	M/50/LSU/5V	C0K510628	C02250628	C02470628	QA/8040/00
PRA/182040/M/200	40	200	G1/4	16	M/50/LSU/5V	C0K510628	C02250628	C02470628	QA/8040/00
PRA/182040/M/250	40	250	G1/4	16	M/50/LSU/5V	C0K510628	C02250628	C02470628	QA/8040/00
PRA/182040/M/320	40	320	G1/4	16	M/50/LSU/5V	C0K510628	C02250628	C02470628	QA/8040/00
PRA/182040/M/400	40	400	G1/4	16	M/50/LSU/5V	C0K510628	C02250628	C02470628	QA/8040/00
PRA/182040/M/500	40	500	G1/4	16	M/50/LSU/5V	C0K510628	C02250628	C02470628	QA/8040/00
PRA/182050/M/25	50	25	G1/4	20	M/50/LSU/5V	C0K510828	C02250828	C02470828	QA/8050/00
PRA/182050/M/50	50	50	G1/4	20	M/50/LSU/5V	C0K510828	C02250828	C02470828	QA/8050/00
PRA/182050/M/80	50	80	G1/4	20	M/50/LSU/5V	C0K510828	C02250828	C02470828	QA/8050/00
PRA/182050/M/100	50	100	G1/4	20	M/50/LSU/5V	C0K510828	C02250828	C02470828	QA/8050/00
PRA/182050/M/125	50	125	G1/4	20	M/50/LSU/5V	C0K510828	C02250828	C02470828	QA/8050/00
PRA/182050/M/160	50	160	G1/4	20	M/50/LSU/5V	C0K510828	C02250828	C02470828	QA/8050/00
PRA/182050/M/200	50	200	G1/4	20	M/50/LSU/5V	C0K510828	C02250828	C02470828	QA/8050/00
PRA/182050/M/250	50	250	G1/4	20	M/50/LSU/5V	C0K510828	C02250828	C02470828	QA/8050/00
PRA/182050/M/320	50	320	G1/4	20	M/50/LSU/5V	C0K510828	C02250828	C02470828	QA/8050/00
PRA/182050/M/400	50	400	G1/4	20	M/50/LSU/5V	C0K510828	C02250828	C02470828	QA/8050/00
PRA/182050/M/500	50	500	G1/4	20	M/50/LSU/5V	C0K510828	C02250828	C02470828	QA/8050/00
PRA/182063/M/25	63	25	G3/8	20	M/50/LSU/5V	C0K510838	C02250838	C02470838	QA/8063/00
PRA/182063/M/50	63	50	G3/8	20	M/50/LSU/5V	C0K510838	C02250838	C02470838	QA/8063/00
PRA/182063/M/80	63	80	G3/8	20	M/50/LSU/5V	C0K510838	C02250838	C02470838	QA/8063/00
PRA/182063/M/100	63	100	G3/8	20	M/50/LSU/5V	C0K510838	C02250838	C02470838	QA/8063/00
PRA/182063/M/125	63	125	G3/8	20	M/50/LSU/5V	C0K510838	C02250838	C02470838	QA/8063/00
PRA/182063/M/160	63	160	G3/8	20	M/50/LSU/5V	C0K510838	C02250838	C02470838	QA/8063/00
PRA/182063/M/200	63	200	G3/8	20	M/50/LSU/5V	C0K510838	C02250838	C02470838	QA/8063/00
PRA/182063/M/250	63	250	G3/8	20	M/50/LSU/5V	C0K510838	C02250838	C02470838	QA/8063/00
PRA/182063/M/320	63	320	G3/8	20	M/50/LSU/5V	C0K510838	C02250838	C02470838	QA/8063/00
PRA/182063/M/400	63	400	G3/8	20	M/50/LSU/5V	C0K510838	C02250838	C02470838	QA/8063/00
PRA/182063/M/500	63	500	G3/8	20	M/50/LSU/5V	C0K510838	C02250838	C02470838	QA/8063/00
PRA/182080/M/25	80	25	G3/8	25	M/50/LSU/5V	C0K511038	C02251038	C02471038	QA/8080/00
PRA/182080/M/50	80	50	G3/8	25	M/50/LSU/5V	C0K511038	C02251038	C02471038	QA/8080/00
PRA/182080/M/80	80	80	G3/8	25	M/50/LSU/5V	C0K511038	C02251038	C02471038	QA/8080/00
PRA/182080/M/100	80	100	G3/8	25	M/50/LSU/5V	C0K511038	C02251038	C02471038	QA/8080/00
PRA/182080/M/125	80	125	G3/8	25	M/50/LSU/5V	C0K511038	C02251038	C02471038	QA/8080/00
PRA/182080/M/160	80	160	G3/8	25	M/50/LSU/5V	C0K511038	C02251038	C02471038	QA/8080/00
PRA/182080/M/200	80	200	G3/8	25	M/50/LSU/5V	C0K511038	C02251038	C02471038	QA/8080/00
PRA/182080/M/250	80	250	G3/8	25	M/50/LSU/5V	C0K511038	C02251038	C02471038	QA/8080/00
PRA/182080/M/320	80	320	G3/8	25	M/50/LSU/5V	C0K511038	C02251038	C02471038	QA/8080/00
PRA/182080/M/400	80	400	G3/8	25	M/50/LSU/5V	C0K511038	C02251038	C02471038	QA/8080/00
PRA/182080/M/500	80	500	G3/8	25	M/50/LSU/5V	C0K511038	C02251038	C02471038	QA/8080/00
PRA/182100/M/25	100	25	G1/2	25	M/50/LSU/5V	C0K511248	C02251248	C02471248	QA/8100/00
PRA/182100/M/50	100	50	G1/2	25	M/50/LSU/5V	C0K511248	C02251248	C02471248	QA/8100/00
PRA/182100/M/80	100	80	G1/2	25	M/50/LSU/5V	C0K511248	C02251248	C02471248	QA/8100/00
PRA/182100/M/100	100	100	G1/2	25	M/50/LSU/5V	C0K511248	C02251248	C02471248	QA/8100/00
PRA/182100/M/125	100	125	G1/2	25	M/50/LSU/5V	C0K511248	C02251248	C02471248	QA/8100/00
PRA/182100/M/160	100	160	G1/2	25	M/50/LSU/5V	C0K511248	C02251248	C02471248	QA/8100/00
PRA/182100/M/200	100	200	G1/2	25	M/50/LSU/5V	C0K511248	C02251248	C02471248	QA/8100/00
PRA/182100/M/250	100	250	G1/2	25	M/50/LSU/5V	C0K511248	C02251248	C02471248	QA/8100/00
PRA/182100/M/320	100	320	G1/2	25	M/50/LSU/5V	C0K511248	C02251248	C02471248	QA/8100/00
PRA/182100/M/400	100	400	G1/2	25	M/50/LSU/5V	C0K511248	C02251248	C02471248	QA/8100/00
PRA/182100/M/500	100	500	G1/2	25	M/50/LSU/5V	C0K511248	C02251248	C02471248	QA/8100/00
PRA/182125/M/160	125	160	G1/2	32	M/50/LSU/5V	C0K511248	C02251248	C02471248	QA/8125/00
PRA/182125/M/200	125	200	G1/2	32	M/50/LSU/5V	C0K511248	C02251248	C02471248	QA/8125/00
PRA/182125/M/250	125	250	G1/2	32	M/50/LSU/5V	C0K511248	C02251248	C02471248	QA/8125/00
PRA/182125/M/320	125	320	G1/2	32	M/50/LSU/5V	C0K511248	C02251248	C02471248	QA/8125/00
PRA/182125/M/400	125	400	G1/2	32	M/50/LSU/5V	C0K511248	C02251248	C02471248	QA/8125/00
PRA/182125/M/500	125	500	G1/2	32	M/50/LSU/5V	C0K511248	C02251248	C02471248	QA/8125/00

Other stroke lengths available please call your Express Team
For information on additional magnetic switches see page 58

If you can't see the option you require...
...call the Express hotline now!

MOUNTINGS FOR PRA/181000/M and PRA/182000/M ISO/VDMA Profile cylinders

Single and double acting

■ Single and Double Acting

■ Double Acting Only

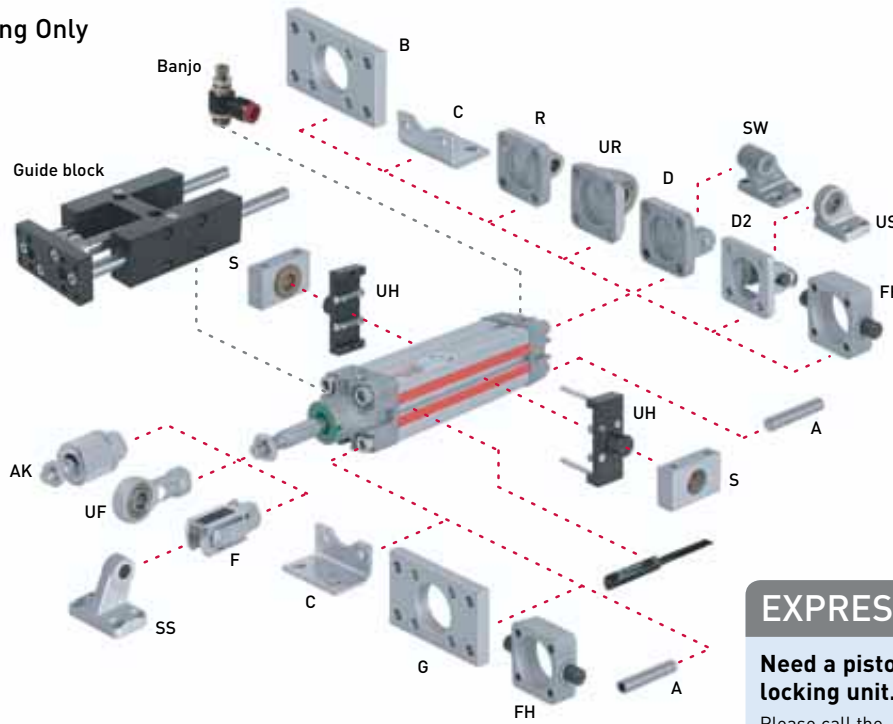

EXPRESS LINKS

Need a piston rod locking unit...

Please call the Express Team



Dia. Ø	A	AK	B, G	C	D	D2	F	FH
32	QM/8032/35	QM/8025/38	QA/8032/22	QA/8032/21	QA/8032/23	QA/8032/42	QM/8025/25	QA/8032/34
40	QM/8032/35	QM/8040/38	QA/8040/22	QA/8040/21	QA/8040/23	QA/8040/42	QM/8040/25	QA/8040/34
50	QM/8050/35	QM/8050/38	QA/8050/22	QA/8050/21	QA/8050/23	QA/8050/42	QM/8050/25	QA/8050/34
63	QM/8050/35	QM/8050/38	QA/8063/22	QA/8063/21	QA/8063/23	QA/8063/42	QM/8050/25	QA/8063/34
80	QM/8080/35	QM/8080/38	QA/8080/22	QA/8080/21	QA/8080/23	QA/8080/42	QM/8080/25	QA/8080/34
100	QM/8080/35	QM/8080/38	QA/8100/22	QA/8100/21	QA/8100/23	QA/8100/42	QM/8080/25	QA/8100/34
125	QM/8125/35	QM/8125/38	QM/8125/22	QM/8125/21	QM/8125/23	QA/8125/42	QM/8125/25	QA/8125/34

Dia. Ø	R	S	SS	SW	UF	UH	UR	US
32	QA/8032/27	QA/8032/41	M/P19931	M/P19493	QM/8025/32	PQA/182032/40	QA/8032/33	M/P40310
40	QA/8040/27	QA/8040/41	M/P19932	M/P19494	QM/8040/32	PQA/182040/40	QA/8040/33	M/P40311
50	QA/8050/27	QA/8040/41	M/P19933	M/P19495	QM/8050/32	PQA/182050/40	QA/8050/33	M/P40312
63	QA/8063/27	QA/8063/41	M/P19934	M/P19496	QM/8050/32	PQA/182063/40	QA/8063/33	M/P40313
80	QA/8080/27	QA/8063/41	M/P19935	M/P19497	QM/8080/32	PQA/182080/40	QA/8080/33	M/P40314
100	QA/8100/27	QA/8100/41	M/P19936	M/P19498	QM/8080/32	PQA/182100/40	QA/8100/33	M/P40315
125	QM/8125/27	QA/8100/41	M/P19937	M/P19499	QM/8125/32	PQA/182125/40	QM/8125/33	M/P71355

Standard strokes for guide blocks

Dia. Ø	Guide Blocks	Guide Blocks
32	QA/8032/51*	QA/8032/61*
40	QA/8040/51*	QA/8040/61*
50	QA/8050/51*	QA/8050/61*
63	QA/8063/51*	QA/8063/61*
80	QA/8080/51*	QA/8080/61*
100	QA/8100/51*	QA/8100/61*

Ø	50	100	160	200	250	320	400	500
32	•	•	•	•	•	•	•	•
40	•	•	•	•	•	•	•	•
50	•	•	•	•	•	•	•	•
63	•	•	•	•	•	•	•	•
80	•	•	•	•	•	•	•	•
100	•	•	•	•	•	•	•	•

* Insert stroke length in mm from table on the right
 Note: QA/8_/_/51* = Plain bearing
 QA/8_/_/61* = Ball bearing

Other stroke lengths are not available, use nearest standard stroke
 Maximum stroke 500 mm

If you can't see the option you require...
 ...call the Express hotline now!